

Flue Gas Particle Filter / Pellet Boiler Filter

ESP-25

Exodraft ESP-25 is an electrostatic flue gas particle filter designed to remove most of the hazardous ultrafine particles contained in the flue gasses from your pellet boiler.

The electrostatic precipitator (ESP) reduces the number of particles by up to 99,5%, and the total particles mass up to >90%.

Model ESP-25

Application	Pellet boilers (non-condensing only)
Boiler performance range	Up to 25 kW
Max. flue gas temperature	200 °C (250 °C shortly)
Min. ambient temperature during operation	-20 °C
Max. ambient temperature during operation	35 °C
IP	24D
Supply voltage	115 - 230 V AC / 50 - 60 Hz
Max. current	0.5 Amp
Power consumption in use	10 - 50 W
High voltage	30 kV / max. 1.7 mA
Housing material	Stainless steel 1.4404 (316L)
Min. distance to flammable material	500 mm
Installation	Build-in, in existing chimney

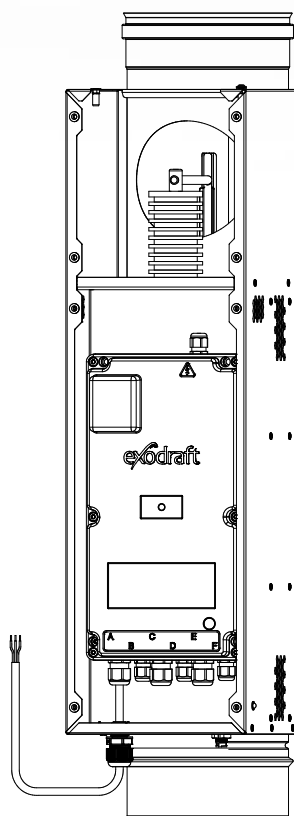

Dimensions & weight

Chimney size - round	Ø150 mm
Height	750 mm
Build-in height	650 mm
Height, housing	603 mm
Width, housing	177 mm
Depth	266 mm
Weight	8 kg



Installation options

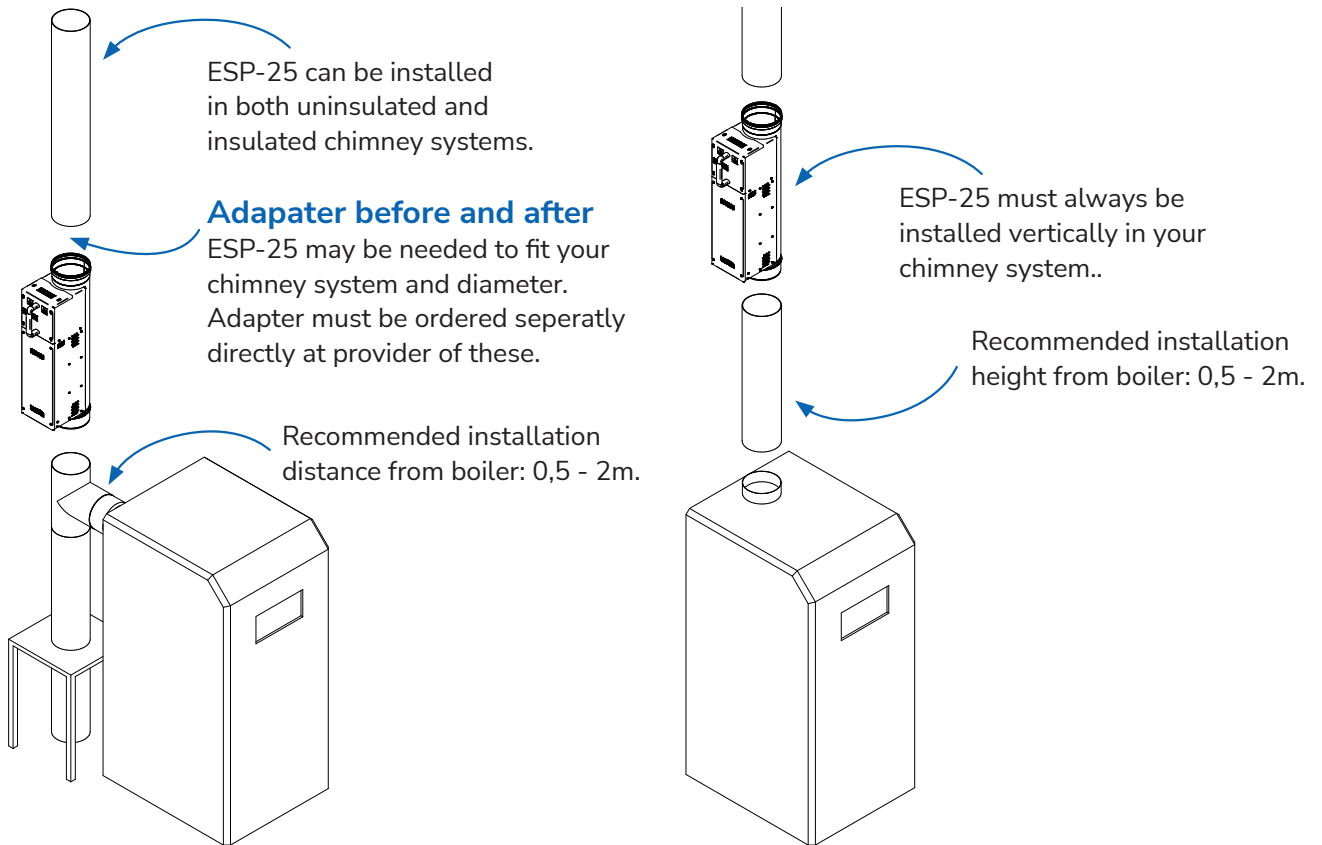

Dimensions

